

# ROTATIVE JOINT ROTATIVE UNION

# PJ 2000

**High Temperature**



- Sealing system by high performance mechanical seal made with graphite with high level of Phenolic Compounds or Antimony. Achieving higher hardness to support fluids with low abrasion (No need lubrication)

MODEL	MEDIA			PRESSURE (MAX.)		TEMPERATURE (MAX.)		SPEED (MAX.) RPM.
	STEAM	AIR	OIL WATER	BAR	PSI	°C	°F	
PJ2000	●	●	●	12	174	350	662	1500RPM

● Recommended ● Not recommended

- Consult Pomier joints for specific details.
- For specific application parameters, see catalog page. Consult Pomier joints for applications requiring increased speeds and pressures.
- Do not operate rotary joint at maximum pressure, temperature and speed simultaneously.



Main Axis made with Stainless Steel



Body made with Cast Iron and Housing with high level of Phenolic Compounds

Single Passage (Unique Flow)  
or Dual Passage (Two way Flow)

For fixed or rotative fitting.  
Push-in Fittings for bipartite fixations.

Available Threads:  
BSP (Right Handed)  
BSP (Left Handed)  
NPT (Right Handed)  
NPT (Left Handed)

AXIS DIAMETER

1/2"	3/4"	1"	1.1/4"
1.1/2"	2"	2.1/2"	3"
4"			

## ADAPTER FLANGE

in case of parts with flange, need to inform its dimensions

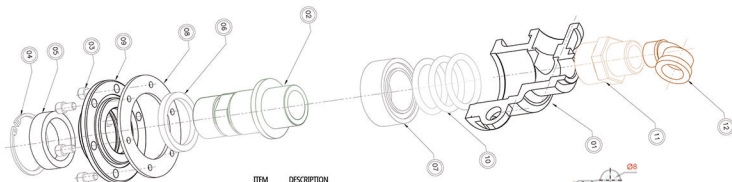
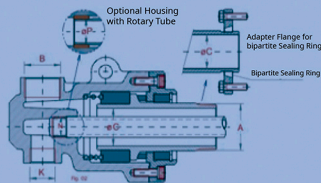
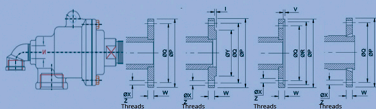

ITEM	DESCRIPTION
01	MANIFOLD
02	MANIFOLD
03	SOCKET HEAD ALLEN SCREW
04	SHAPING FOR AXES
05	END-FLANGE HOUSING
06	CONCAVE HOUSING
07	REGULINE SPRING HOUSING
08	GASKET
09	UPPER COVER
10	PRESSURE SPRING
11	HEXAGONIC CONICAL FITTING
12	90° ELBOW FITTING

\*Items 11 and 12 are used with Rotary joints with Two way flow and all fitting style (body or Flange).

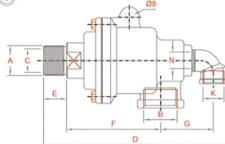

# DIMENSIONAL SHEET

## ROTATIVE JOINT PJ2000 - HIGH TEMPERATURE

1/2" Thread A	Unique Flow	Thread B	Ø C	D	E	F	1/2" Thread A	Two Way Flow	Thread B	Ø C	D	E	F	G	K	N Fixed	ØP Rotative	RPM
BSP RH	PJ2001-U	1/2"	20	185	24	94	BSP LH	PJ2002-D	1/2"	20	185	24	94	52	1/4"	1/8"	12	1.500
BSP LH	PJ2003-U	1/2"	20	185	24	94	BSP RH	PJ2004-D	1/2"	20	185	24	94	52	1/4"	1/8"	12	1.500
NPT RH	PJ2005-U	1/2"	20	185	24	94	NPT LH	PJ2006-D	1/2"	20	185	24	94	52	1/4"	1/8"	12	1.500
NPT LH	PJ2007-U	1/2"	20	185	24	94	NPT RH	PJ2008-D	1/2"	20	185	24	94	52	1/4"	1/8"	12	1.500

3/4" Thread A	Unique Flow	Thread B	Ø C	D	E	F	3/4" Thread A	Two Way Flow	Thread B	Ø C	D	E	F	G	K	N Fixed	ØP Rotative	RPM
BSP RH	PJ2009-U	3/4"	20	185	24	94	BSP LH	PJ2010-D	3/4"	20	185	24	94	52	1/2"	1/4"	12	1.500
BSP LH	PJ2011-U	3/4"	20	185	24	94	BSP RH	PJ2012-D	3/4"	20	185	24	94	52	1/2"	1/4"	12	1.500
NPT RH	PJ2013-U	3/4"	20	185	24	94	NPT LH	PJ2014-D	3/4"	20	185	24	94	52	1/2"	1/4"	12	1.500
NPT LH	PJ2015-U	3/4"	20	185	24	94	NPT RH	PJ2016-D	3/4"	20	185	24	94	52	1/2"	1/4"	12	1.500

1" Thread A	Unique Flow	Thread B	Ø C	D	E	F	1" Thread A	Two Way Flow	Thread B	Ø C	D	E	F	G	K	N Fixed	ØP Rotative	RPM
BSP RH	PJ2017-U	1"	24	185	24	94	BSP LH	PJ2018-D	1"	24	185	24	94	52	1/2"	3/8"	16	1.500
BSP LH	PJ2019-U	1"	24	185	24	94	BSP RH	PJ2020-D	1"	24	185	24	94	52	1/2"	3/8"	16	1.500
NPT RH	PJ2021-U	1"	24	185	24	94	NPT LH	PJ2022-D	1"	24	185	24	94	52	1/2"	3/8"	16	1.500
NPT LH	PJ2023-U	1"	24	185	24	94	NPT RH	PJ2024-D	1"	24	185	24	94	52	1/2"	3/8"	16	1.500

1.1/4" Thread A	Unique Flow	Thread B	Ø C	D	E	F	1.1/4" Thread A	Two Way Flow	Thread B	Ø C	D	E	F	G	K	N Fixed	ØP Rotative	RPM
BSP RH	PJ2025-U	1.1/4"	30	265	30	128	BSP LH	PJ2026-D	1.1/4"	30	265	30	128	88	3/4"	1/2"	20	1.000
BSP LH	PJ2027-U	1.1/4"	30	265	30	128	BSP RH	PJ2028-D	1.1/4"	30	265	30	128	88	3/4"	1/2"	20	1.000
NPT RH	PJ2029-U	1.1/4"	30	265	30	128	NPT LH	PJ2030-D	1.1/4"	30	265	30	128	88	3/4"	1/2"	20	1.000
NPT LH	PJ2031-U	1.1/4"	30	265	30	128	NPT RH	PJ2032-D	1.1/4"	30	265	30	128	88	3/4"	1/2"	20	1.000

1.1/2" Thread A	Unique Flow	Thread B	Ø C	D	E	F	1.1/2" Thread A	Two Way Flow	Thread B	Ø C	D	E	F	G	K	N Fixed	ØP Rotative	RPM
BSP RH	PJ2033-U	1.1/2"	38	266	30	128	BSP LH	PJ2034-D	1.1/2"	38	266	30	128	88	3/4"	3/4"	25	1.000
BSP LH	PJ2035-U	1.1/2"	38	266	30	128	BSP RH	PJ2036-D	1.1/2"	38	266	30	128	88	3/4"	3/4"	25	1.000
NPT RH	PJ2037-U	1.1/2"	38	266	30	128	NPT LH	PJ2038-D	1.1/2"	38	266	30	128	88	3/4"	3/4"	25	1.000
NPT LH	PJ2039-U	1.1/2"	38	266	30	128	NPT RH	PJ2040-D	1.1/2"	38	266	30	128	88	3/4"	3/4"	25	1.000

2" Thread A	Unique Flow	Thread B	Ø C	D	E	F	2" Thread A	Two Way Flow	Thread B	Ø C	D	E	F	G	K	N Fixed	ØP Rotative	RPM
BSP RH	PJ2041-U	2"	48	317	33	169	BSP LH	PJ2042-D	2"	48	317	33	169	97	1"	1"	32	850
BSP LH	PJ2043-U	2"	48	317	33	169	BSP RH	PJ2044-D	2"	48	317	33	169	97	1"	1"	32	850
NPT RH	PJ2045-U	2"	48	317	33	169	NPT LH	PJ2046-D	2"	48	317	33	169	97	1"	1"	32	850
NPT LH	PJ2047-U	2"	48	317	33	169	NPT RH	PJ2048-D	2"	48	317	33	169	97	1"	1"	32	850

2.1/2" Thread A	Unique Flow	Thread B	Ø C	D	E	F	2.1/2" Thread A	Two Way Flow	Thread B	Ø C	D	E	F	G	K	N Fixed	ØP Rotative	RPM
BSP RH	PJ2049-U	2.1/2"	48	317	33	169	BSP LH	PJ2050-D	2.1/2"	48	317	33	169	97	1"	1"	32	850
BSP LH	PJ2051-U	2.1/2"	48	317	33	169	BSP RH	PJ2052-D	2.1/2"	48	317	33	169	97	1"	1"	32	850
NPT RH	PJ2053-U	2.1/2"	48	317	33	169	NPT LH	PJ2054-D	2.1/2"	48	317	33	169	97	1"	1"	32	850
NPT LH	PJ2055-U	2.1/2"	48	317	33	169	NPT RH	PJ2056-D	2.1/2"	48	317	33	169	97	1"	1"	32	850

3" Thread A	Unique Flow	Thread B	Ø C	D	E	F	3" Thread A	Two Way Flow	Thread B	Ø C	D	E	F	G	K	N Fixed	ØP Rotative	RPM
BSP RH	PJ2057-U	3"	70	460	54	230	BSP LH	PJ2058-D	3"	70	460	54	230	150	1"	1"	32	700
BSP LH	PJ2059-U	3"	70	460	54	230	BSP RH	PJ2060-D	3"	70	460	54	230	150	1"	1"	32	700
NPT RH	PJ2061-U	3"	70	460	54	230	NPT LH	PJ2062-D	3"	70	460	54	230	150	1"	1"	32	700
NPT LH	PJ2063-U	3"	70	460	54	230	NPT RH	PJ2064-D	3"	70	460	54	230	150	1"	1"	32	700

4" Thread A	Unique Flow	Thread B	Ø C	D	E	F	4" Thread A	Two Way Flow	Thread B	Ø C	D	E	F	G	K	N Fixed	ØP Rotative	RPM
BSP RH	PJ2065-U	4"	70	460	54	230	BSP LH	PJ2066-D	4"	70	460	54	230	150	1"	1"	32	700
BSP LH	PJ2067-U	4"	70	460	54	230	BSP RH	PJ2068-D	4"	70	460	54	230	150	1"	1"	32	700
NPT RH	PJ2069-U	4"	70	460	54	230	NPT LH	PJ2070-D	4"	70	460	54	230	150	1"	1"	32	700
NPT LH	PJ6071-U	4"	70	460	54	230	NPT RH	PJ2072-D	4"	70	460	54	230	150	1"	1"	32	700